

## Welcome to The Hall

We are glad to inform you that The Hall is wheelchair-accessible. To help you find your way quickly and easily, we have compiled some information for you.

### Parking

The four parking spaces for disabled guests are located in our underground car park on levels U1 and U2 directly next to the exit (see map below). The lift takes you from the car park to the ground floor level, from where you proceed to the outside entrance. Please ask the staff about availabilities in case the sign outside mentions no vacancy.

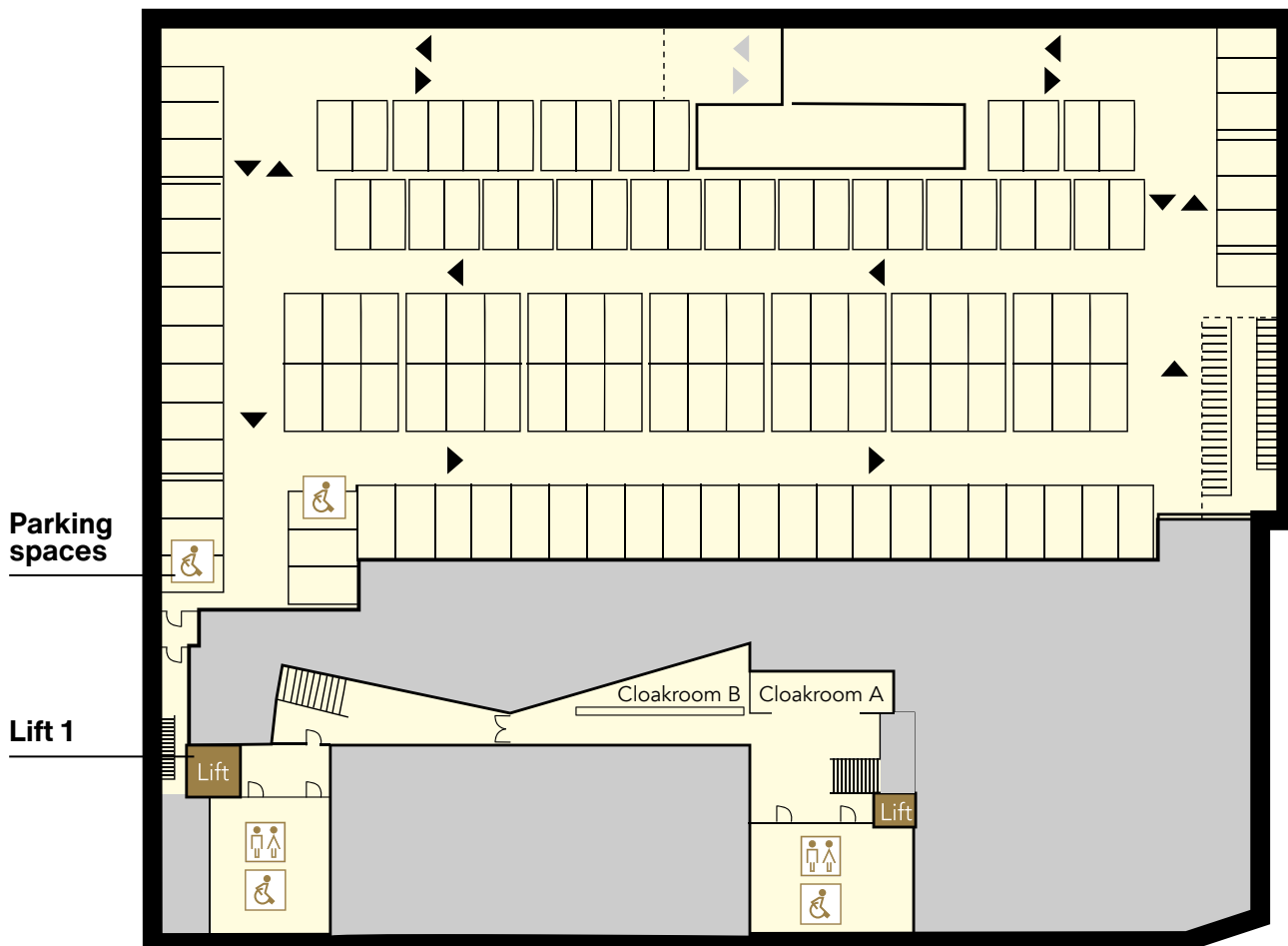



# THE HALL

## Elevators and Toilets

The elevators are located on the left side towards the balcony and on the right side (or, rather, built into the staircase) of the main entrance. All these lifts also take you to the basement to the wheelchair-friendly toilets on level -1. The toilets on level 2 near the balcony are not wheelchair-accessible.

## Cloakrooms, Smoking Area and Emergency Exits

The lifts take you to the wardrobes located on level -1. The smoking terrace is on level 2. Please have a look at the position of the emergency exits on the floor plans. In case you are in the basement or on the upper floor, follow the escape routes until you reach a safe section. From there you will be escorted outside by our evacuation assistants.

We hope you enjoy your stay with us. If you need support or further information, do not hesitate to contact us. Our staff (in green vests) or our security personnel will be pleased to support you.

Enjoy your stay at The Hall!

Kind regards

**The Hall Team**

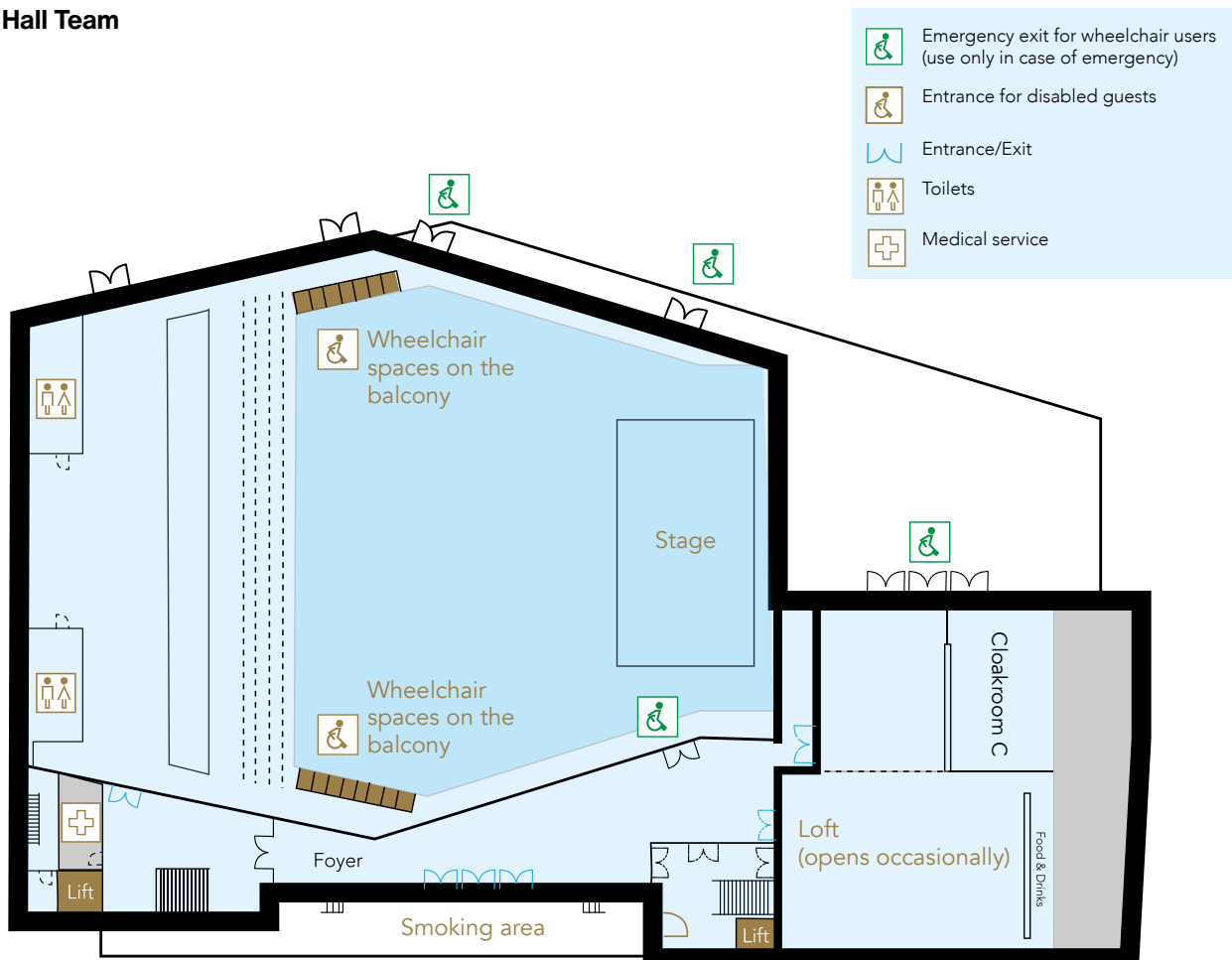

**Location Map Level 2 > Balcony of The Hall**